

FOR INFORMATIONAL PURPOSES ONLY

**NOTES**

This sheet shall be used with the Temporary Traffic Control General Notes Sheets TTC-00(A), TTC-00(B), and TTC-00(C).

1. This layout represents the minimum traffic controls required for moving operations on two-lane roads with two-way traffic, such as striping, street sweeping, and placement of raised pavement markers.
2. Distances between vehicles may vary and should be adjusted due to drying time and sight obstructions such as overpasses and hills. Vehicles with attenuators shall move with work operations. Buffer space shall not exceed rollover distance required by the manufacturer plus 100 feet.
3. If a queue greater than 5 minutes (about 1000 feet) exists, the contractor shall cease operations and pull over to the shoulder until the queue dissipates.
4. Flaggers may be used with this layout, if needed. See TTC-00(B).

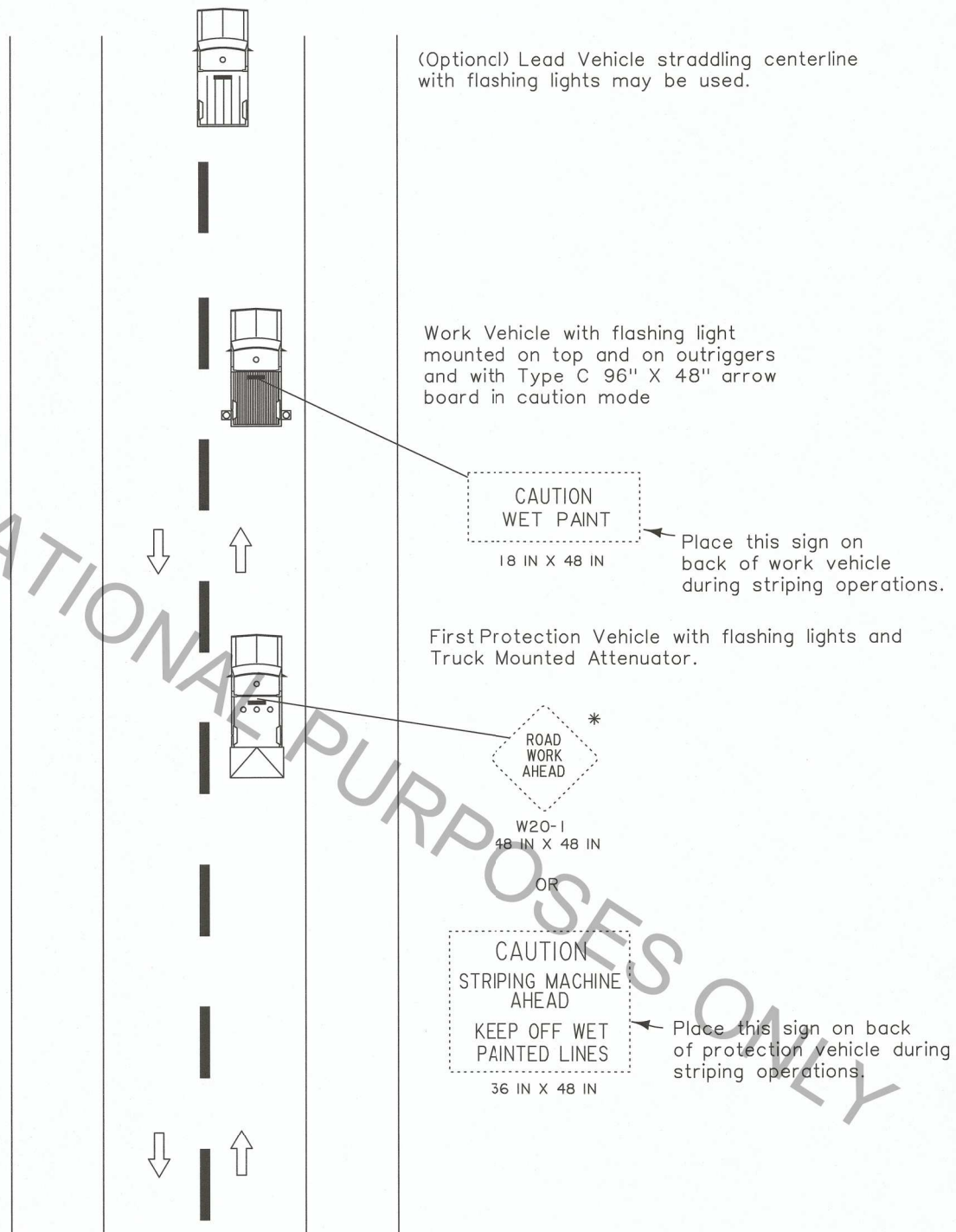

ALL TTC STANDARDS SHOW MINIMUM CONSTRUCTION SIGNING.  
ALL SITUATIONS SHALL BE REVIEWED AND/OR DESIGNED BY THE ENGINEER.  
CONTRACTORS ARE RESPONSIBLE FOR COMPLYING WITH ALL TTC STANDARDS.

\* Any sign of the W20-1 series may be used.

**LEGEND**

- Direction of Travel
- Work Vehicle
- Lead Vehicle
- Protection Vehicle



SHEET NUMBER		PARISH		CONTROL SECTION		STATE PROJECT	
DESIGNED	G. LEBLANC	CHECKED	J. COLVIN	DETAILED	C. FAKOURI	CHECKED	G. LEBLANC
SERIES NUMBER		BY		DATE		REVISION OR CHANGE ORDER DESCRIPTION	
				7/2/18			
APPROVED BY CHIEF ENGINEER:		 Gary N. LeBlanc 6-27-18					
TEMPORARY TRAFFIC CONTROL FOR MOVING OPERATIONS ON TWO-WAY TWO-LANE ROADWAYS		TTC-18					
		TRAFFIC ENGINEERING					